

TOPCON BIFACIAL MODULE SEMI+SMBB

SL5N108 | 425 WATT

ELECTRICAL DATA	STC	NMOT
Rated Power In Watts-Pmax (Wp)	425	322
Maximum Power Voltage-Vmpp (V)	32.05	30.11
Maximum Power Current-Impp (A)	13.26	10.7
Open Circuit Voltage-Voc (V)	38.23	36.38
Short Circuit Current-Isc (A)	14.08	11.27
Module Efficiency (%)	21.8%	/

STC: Irradiation 1000 W/m², Cell Temperature 25°C, Air Mass AM1.5 according to EN 60904-3.
NOCT: Irradiation: 800 W/m², ambient temperature: 20°C, air mass: 1.5, wind speed 1 m/s

Electrical Characteristics With Different Rear Side Power Again (Reference To 425w Front)				
Pmax gain (%)	5%	10%	15%	20%
Maximum Power (Pmax/W)	446	468	489	510
Maximum Power Voltage (Vmpp/V)	32.05	32.05	32.05	32.05
Maximum Power Current (Impp/A)	13.92	14.59	15.25	15.91

MECHANICAL CHARACTERISTICS	
Solar Cells	Monocrystalline N-type, SMBB
Cell Configuration	108 cells (6 x 9 x 2)
Module Dimensions	1722 x 1134 x 30 mm
Weight	22.0 kg
Glass	1.6mm Tempered ARC Glass
Back Sheet	1.6mm Glass, Black
Frame	Anodized Aluminium Alloy, Black
J-Box	IP68, 3 bypass diodes
Cables	4.0mm, (+) 380mm, (-) 380mm or customized length
Connector	MC4 Compatible

TEMPERATURE & MAXIMUM RATINGS	
Nominal Module Operating Temperature (NMOT)	44±2°C
Temperature Coefficient of VOC	-0.25% / °C
Temperature Coefficient of ISC	0.045% / °C
Temperature Coefficient of PMAX	-0.30% / °C
Operational Temperature	-40°C~+85°C
Maximum System Voltage	1500VDC
Max Series Fuse Rating	25A

PACKAGING CONFIGURATION	
	40 FT (HQ)
Number of Modules Per Container	936
Number of Modules Per Pallet	36
Number of Pallets Per Container	26

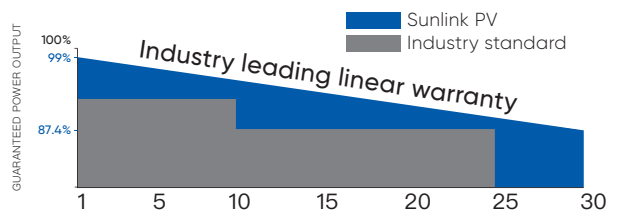
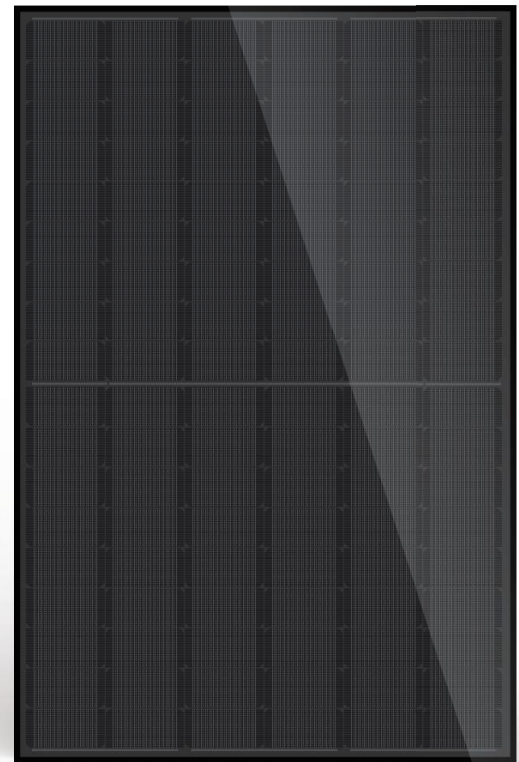

15 years product warranty | 30 years linear performance warranty

TOPCON BIFACIAL MODULE

SL5N108 | 425 WATT

BACK OVERVIEW

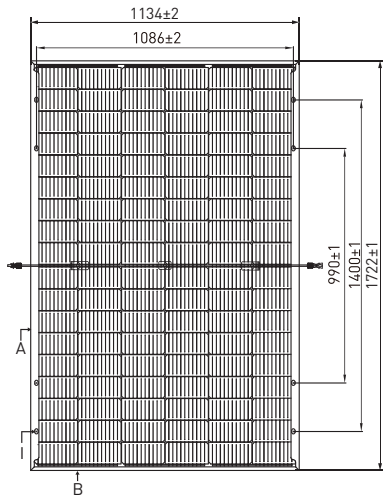

DRAWINGS (MM)

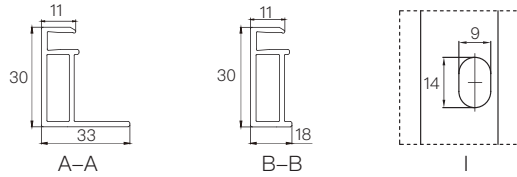

CURRENT-VOLTAGE & POWER-VOLTAGE CURVES (SL5N108)

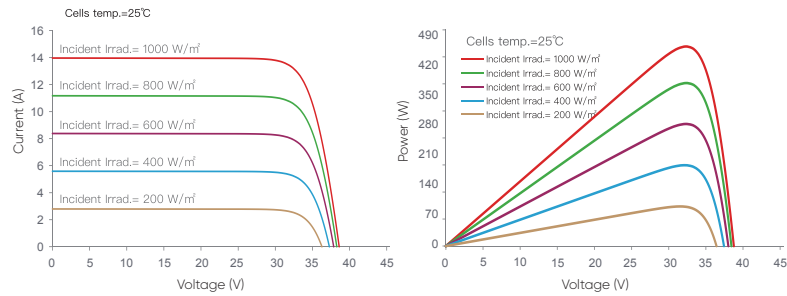

HIGH LIGHTS

$$+ \frac{W}{m^2}$$

HIGHER EFFICIENCY

Module efficiency high to 21.8% ensure less BOS cost

Gain more solar power per square meter

$$\frac{15}{30}$$

LONGER WARRANTY

N-type TOPCON technology ensures 15-year product warranty and 30-year power warranty

$$\leq 1\%$$

$$\leq 0.4\%$$

LESS DEGRADATION

1st year degradation < 1%

Annual degradation < 0.4%

$$\geq 75\%$$

HIGHER BIFACIALITY

75%-80% Bifaciality ensures to gain more solar energy from backside

$$\frac{\%}{^{\circ}C}$$

$$-0.3$$

LOWER TEMPERATURE COEFFICIENT OF P_{MAX}

TOPCON modules' coefficient of P_{max} low to -0.3%/C helps gaining more power at sunny days.